

SPECIAL PROVISION (DRY HYDRANT)

STA. 61+34.00 - 62+04.92 LT

DELINEATOR WITH STEEL POST (TYPE 1)

STA. 59+84 LT (GREEN)  
STA. 59+81 RT (BLUE)

REMOVAL AND DISPOSAL OF GUARDRAIL

STA. 60+43.09 - 60+84.28 RT  
STA. 59+22.82 - 60+85.48 LT  
STA. 61+50.29 - 63+37.35 RT  
STA. 61+49.41 - 62+25.00 LT

HEAVY DUTY STEEL BEAM GUARDRAIL, GALVANIZED

STA. 59+69.40 - 60+58.90 LT  
STA. 59+61.67 - 60+57.17 RT  
STA. 62+09.73 - 62+25.00 LT  
STA. 62+10.04 - 62+25.00 RT

ANCHORS FOR HEAVY DUTY STEEL BEAM GUARDRAIL

STA. 59+78.90 LT  
STA. 59+75.00 RT

CONSTRUCT DRIVE

STA. 57+58 LT, 19' - GRAVEL  
STA. 58+11 LT, 14' - GRAVEL  
STA. 57+97 RT, 12' - GRAVEL

REMOVAL OF EXISTING FENCE

STA. 58+50 - STA. 61+00 RT  
STA. 59+00 - STA. 60+00 LT  
STA. 62+15 - STA. 62+20 LT

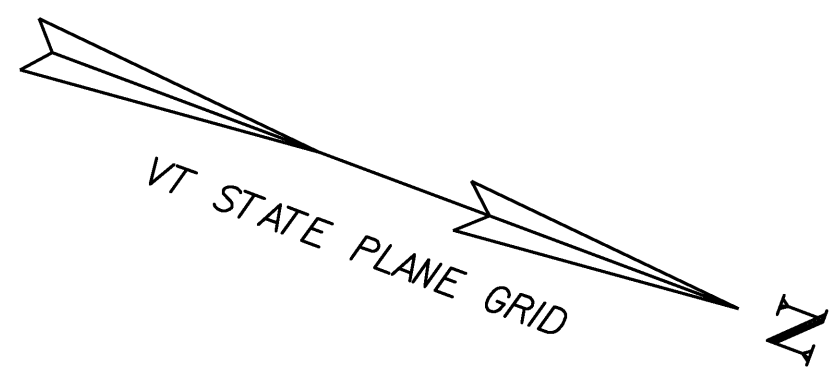

4" YELLOW LINE (DOUBLE)

STA. 57+50 - 62+25

4" WHITE LINE

STA. 57+50 - 62+25 LT  
STA. 57+50 - 62+25 RT

**BEGIN R.O.W. PROJECT**  
**ER ST 0271(16)**  
**STA. 56+21.00**  
**33.44 RT.**

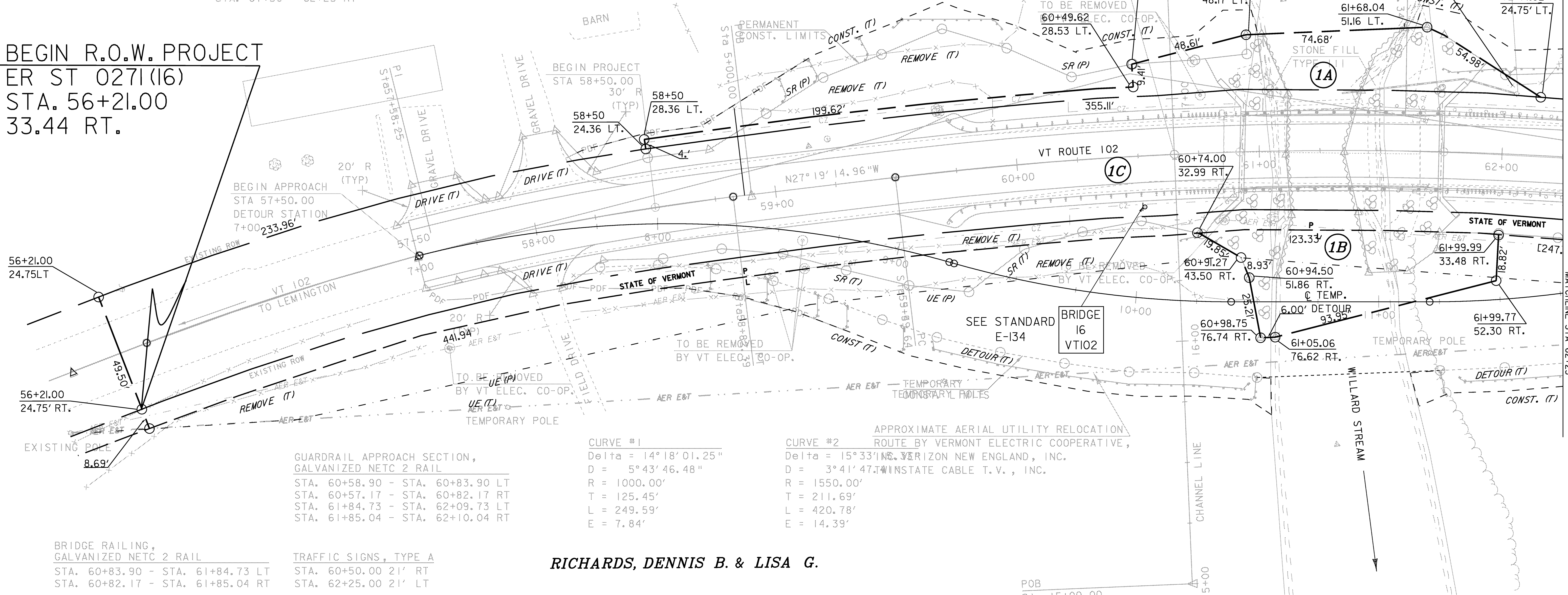

GUARDRAIL APPROACH SECTION, GALVANIZED NETC 2 RAIL

STA. 60+58.90 - STA. 60+83.90 LT  
STA. 60+57.17 - STA. 60+82.17 RT  
STA. 61+84.73 - STA. 62+09.73 LT  
STA. 61+85.04 - STA. 62+10.04 RT

TRAFFIC SIGNS, TYPE A

STA. 60+50.00 21' RT  
STA. 62+25.00 21' LT

CURVE #1  
Delta = 14°18'01.25"  
D = 5°43'46.48"  
R = 1000.00'  
T = 125.45'  
L = 249.59'  
E = 7.84'

CURVE #2  
Delta = 15°33'10.00"  
D = 3°41'47.14"  
R = 1550.00'  
T = 211.69'  
L = 420.78'  
E = 14.39'

BRIDGE RAILING, GALVANIZED NETC 2 RAIL

STA. 60+83.90 - STA. 61+84.73 LT  
STA. 60+82.17 - STA. 61+85.04 RT

PREVIOUS BRIDGE DATA

SINGLE SPAN OPEN BOTTOM CONCRETE ARCH - DESTROYED IN 2004 FLOOD  
CLEAR SPAN (NORMAL TO STREAM): 31 FEET MIN.  
OVERALL LENGTH: 34.5 FEET BACK TO BACK OF ABUTMENTS  
VERTICAL CLEARANCE: 7 FEET  
BRIDGE WIDTH: +/- 34.5 FEET FACE OF RAIL TO FACE OF RAIL

CURRENT STRUCTURE

WIDTH: 24  
LENGTH: 80

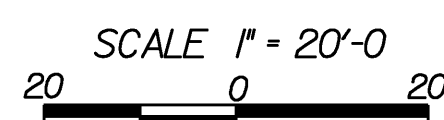

LINES SHOWN ON THIS PLAN AS EXISTING PROPERTY LINES P/L ARE BELIEVED TO BE ACCURATE BUT SHOULD NOT BE RELIED UPON FOR PURPOSES UNRELATED TO THE STATE OF VERMONT'S ACQUISITION OF LAND AND RIGHTS FOR THIS PROJECT.

**RICHARDS, DENNIS B. & LISA G.**

**ROW LAYOUT SHEET #1**

PROJECT NAME: Canaan	PLOT DATE: 18-AUG-2008
PROJECT NUMBER: ER ST 0271(16)	DRAWN BY: L. DUQUETTE
FILE NAME: 04c098\struc\04c098bdr	CHECKED BY: S. SCRIBNER
PROJECT LEADER: M. Evans-Mongeon	DESIGNED BY: S. SCRIBNER
ROW SHEET 14 OF 15	SHEET 9 OF 66